

# Showcase

## San Francisco International Airport Long-term Parking Garage

San Francisco, CA, U.S.A.

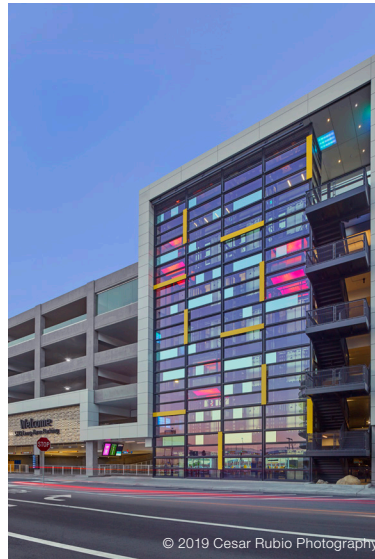
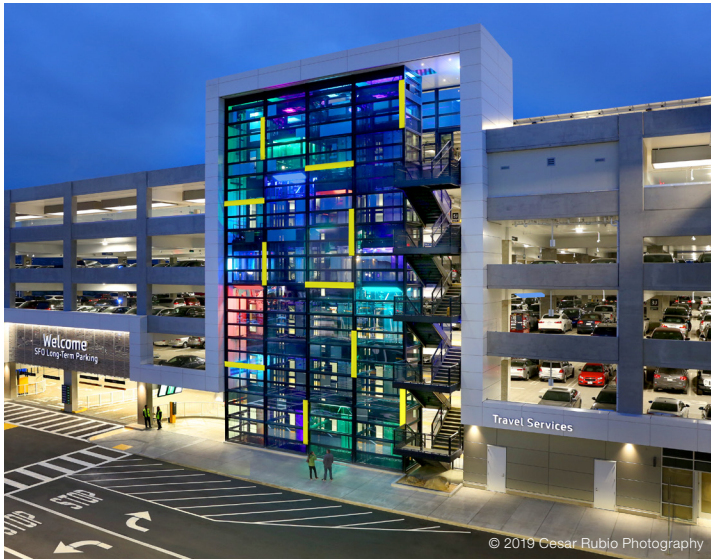

San Francisco International Airport recently wrapped up construction on a new long-term parking facility, and that garage is now home to one of the airport's newest, permanent art installations. The LED lighting display, titled "Coding," was designed by artist, Johanna Grawunder, and features products and controls exclusively from Traxon e:cue.

This art installation uses Traxon e:cue dynamic lighting solutions and controls including Dot XL-9 and Washer Quattro with SYMPHOLIGHT control, to create a subtle light show that is visible both day and night. The products are installed along the building's steel beams and mirrored windows, creating a dot and dash effect, spelling "San Francisco" in Morse code on the elevator shaft.

"Coding" is now one of many art installations located at San Francisco International Airport, making it not just a place for travel, but a cultural destination.

### Traxon Technologies

For more information, please visit [www.osram.us/traxon](http://www.osram.us/traxon)  
Or email us at [information.traxon@traxontechnologies.com](mailto:information.traxon@traxontechnologies.com)

OSRAM, Traxon and e:cue are registered trademarks. All other trademarks are those of their respective owners.  
Specifications subject to change without notice.

### Our Brands

traxon e:cue

### Featured Products



Dot XL-9 RGB



Washer Quattro RGBW

### Methods of Control



Lighting Control Engine 2



SYMPL DMX Node  
SYMPL Serial Node  
SYMPL Input Node  
SYMPHOLIGHT Software

### Project Details

#### Category:

Architecture

#### Location:

San Francisco, CA

#### Client:

San Francisco International Airport /  
San Francisco Arts Commission

#### Lighting Designer:

Johanna Grawunder

#### Programmer:

KrohTech

#### Completion Date:

April 2019

OSRAM